

Experience a "New Beginning"

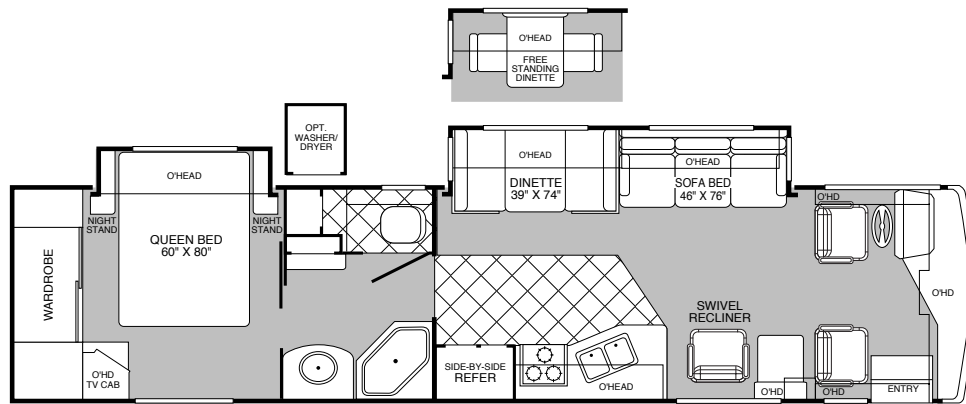

Model
37U

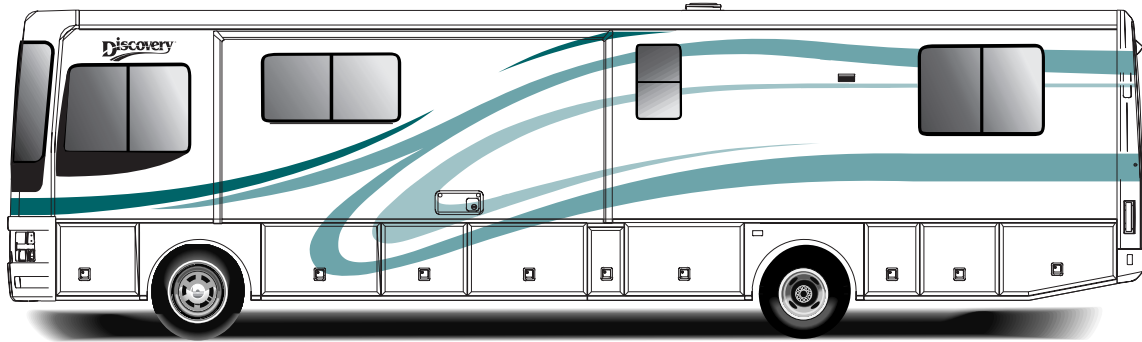
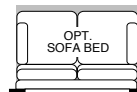

Model
38D

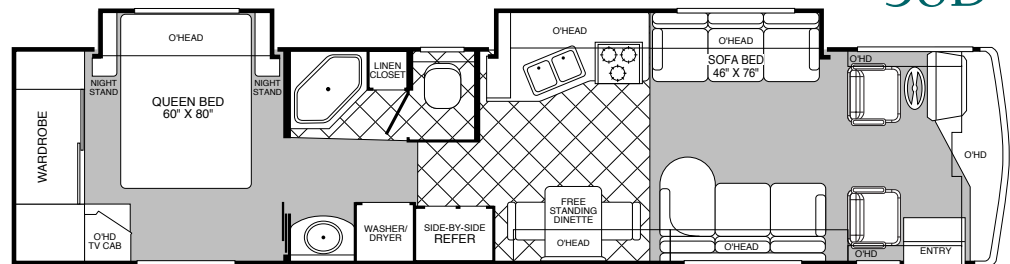

New Features

- New Bedroom Slide
- Flush Floor Living Room Slide
- 50 AMP Electrical Service
- Power Platform
- 330 HP Caterpillar Engine
- New Exterior Graphics
- 7.5 Diesel Generator Standard
- Royal Tuff Ply™ Roof



Discovery Specifications & Features

Automotive/Performance

| | |
|---|---|
| Chassis..... | Freightliner |
| Engine..... | 330 HP CAT / 7.2 liter/ 860 ft./lbs Torque |
| Transmission | 3000MH 6 Sp. |
| Wheel Base | 37U - 242"/38D - 252" |
| GVWR (lbs./kgs.) ¹ | 26,500/12,021 |
| Front GAWR (lbs./kgs.) ² .. | 9,500/4,310 |
| Rear GAWR (lbs./kgs.) ² .. | 17,000/7,712 |
| Base Weight (lbs./kgs.) ³ .. | 19,625/8,900 |
| Hitch Rating (lbs./kgs.) .. | 5,000/2,268 |
| Maximum Tongue Weight (lbs./kgs.)..... | 500/227 |

Dimensions

| | |
|--|--------------|
| Overall Length ³ | 37'-9"/38'9" |
| Overall Height with A/C | 12'1" |
| Overall Width (Maximum) ⁶ | 102" |
| Interior Height (Maximum) | 79" |
| Interior Width (Maximum) | 96" |

Liquid Capacities (gal.)

| | |
|---------------------------------------|----|
| Fresh Water Tank | 80 |
| Black Water Tank | 50 |
| Grey Water Tank | 65 |
| Appliance LPG Tank ⁷ | 24 |
| Fuel Tank - Specific Chassis..... | 90 |

Exterior Automotive & Electrical

- Large Curved Aerodynamic Windshield
- Undercoating
- Stainless Steel Simulators
- Rear Wheel Valve Extenders
- Mud Flaps
- Under Hood Utility Light
- Steel Surface on Bulkhead
- Trailer Hitch with 7-Point Electrical Hook-Up
- Rear Vision Camera
- Windshield Wipers with Wet Arm

Interior Automotive

- Intermittent Wiper Control
- Multi-Function Sun Visor
- Cruise Control
- Radio with Cassette AM/FM/MX Electronic Tune
- Auxiliary Start Circuit
- Battery Shut-Off Switch
- Auto A/C-Heater Combo
- Radio Switch - Main/Aux.
- Soft Surface Automotive Dash - Vinyl
- Tilt Steering Wheel
- Driver/Passenger Captain Chairs with Reclining Back/Slide Controls

Platform Construction

- Basement Floor Configuration
- Polyethylene Luggage Compartment Boxes

- Paco Beams
- Box Vibration Isolators

Body Structure

- Vacubond Lower Floor
- Vacubond Upper Floor
- Vacubond Walls with Smooth Exterior Fiberglass
- Aluminum Wall/Ceiling Framing
- Interlocking Aluminum Extrusions
- Radius Roof with Duct for A/C
- Royal Tuff Ply™ Roof

Slide-Out

- Living Room/Dinette
- Bedroom

Appliances

- Front 27" TV in Overhead
- Rear 20" TV
- Smoke Detector/Alarm
- LPG Detector/Alarm
- CO Detector/Alarm
- Furnace 20M BTU/34M (Dual)
- 10 Gallon Quick Recovery Water Heater with DSI
- 22"-3 Sealed Burner High Output Cooktop
- Light/Power Rangehood and Monitor Panel
- Folding Range Cover
- Dual Roof A/C - High Efficiency with Solar Panel
- Water Heater By-Pass
- Marine Porcelain Toilet
- Convection Microwave
- 12 Cu. Ft. Refrigerator (Large Double Doors)
- Single Lever Galley Faucet
- Water Filter with Faucet
- Demand Water Pump with Filter
- Fan-Tastic® Power Roof Vent Bath and Galley
- Fire Extinguisher
- Phone Jack, Dash and Bedroom
- Rear Speakers in Bedroom
- A/C Ready
- Coffee Maker

Electrical

- Patio Receptacle
- 120V/12V AC/DC Convert. Central Electrical
- 120V/12V Wire Raceway
- Water Pump Switching
- 7.5 KW Generator - Quite Diesel
- 50 AMP Service - Energy Management System
- 2000 Watt Inverter
- Wall Switches
- Four 6V/Deep Cycle 218 AMP House Batteries

Interior

- Number of Fabric Colors - 3
- Number of Cabinetry Choices - 2
- Skylight in Tub/Shower
- Glass Shower Door with Bright Brass Frame
- Wood Grain
- Wall to Wall Nylon Carpet
- Carpet Pad
- Tile Flooring at Galley
- Wood Drawers
- Roller Guide Drawer Slides with Transit Ship Locks
- Radius Corner Cabinetry
- Reclining Bucket Seats
- 3-Point Front Seat Belts
- Bedspread with Decor Pillows
- Innerspring Mattress
- Cabinet Doors and Drawers
- Solid Surface Galley and Lavy Countertops
- Crown Molding
- Beveled Mirrors
- Cedar Lining in Wardrobe
- Window Coverings
- Bath Door Trims
- Wood Trim Table Tops
- Trash Basket in Galley
- Molded Fiberglass Tub/Shower with One-Piece Enclosure
- Bright Brass Bath Accessories
- Residential Seat Styling
- Entry Rail (Stainless Steel)
- Raised Panel Cabinet Doors
- Adjustable Cabinet Shelves (Selected Cabinets)
- Sink Cutting Board
- Solid Divider Doors
- Large Double Porcelain Sink (Galley)
- Porcelain Sink (Lavy)

Interior Lighting

- Wardrobe Lighting
- Fluorescent Ceiling with Dual Bulb
- Incandescent Lighting
- Wall Sconces
- Make-Up Lights in Bath

Exterior

- Full Fiberglass Front Cap
- Full Fiberglass Rear Cap
- Fiberglass Front Quarter Panels
- Fiberglass Rear Wheel Trim
- Aerodynamic Bus Styling
- Radius Door Entry with Deadbolt Latch
- Slider Window
- Utility Compartment
- Hydraulic Levers - 4-Point Manual

- Roof Ladder with Extension
- Radius Torque Window in Bedroom
- Remote Rearview Mirror
- 20' Sewer Hose
- Park Cable Receptacle
- Awning Rail/Drip Molding (Both Sides)
- Power Entry Step
- Battery Charge Control
- Porch Lights (2)
- 3 Colorway Graphics to Match Decor

Exterior Storage

- Insulated Luggage Doors
- Single Padded/Metal Latches
- Continuous One-Piece Bulb Seal
- Hidden Stainless Steel Latch Rods
- Gas Lift Strut Supports
- Lights in Compartments

Sleeping Accommodations

- Magic Bed Convertible Sofa
- Dinette
- Queen Bed

Optional Equipment

- Free-Standing Dinette
- Range 3 Sealed Burner Drop-In Washer/Dryer
- Central Vacuum System
- DSS Manual Lift/Satellite Dish
- Awning - USA
- Front Mask
- Aluminum Rims
- Spotlight with Remote Control
- Roof Mount Chrome Air Horn
- CB Radio Ready
- Stereo AM/FM with CD Player
- Power Seat - Driver
- Leather Heated Power Driver and Passenger Seats
- GPS Navigation System
- Bedroom Radio
- Leather Sofa Bed
- Leather Swivel Recliner
- Free-Standing Dinette Table and Chairs
- Multiple CD Changer
- DVD Player
- Home Theater Sound System
- Walnut Wood Grain
- Leather Love Seat
- Entertainment Package
- Power Awning - USA

1. GVWR (Gross Vehicle Weight Rating): Means the maximum permissible loaded weight of the motor home. The GVWR is equal to or greater than the sum of the unloaded vehicle weight plus the net carrying capacity.

2. GAWR (Gross Axle Weight Rating): Means the maximum permissible loaded weight a specific axle is designed to carry.

3. Base Weight: Means the weight of the motor home without fuel, options, water, cargo or passengers.

4. GCWR (Gross Combined Weight Rating): Means the value specified by the motor home manufacturer as the maximum allowable loaded weight of this motor home with its towed vehicle. Towing and braking capacities may differ. Refer to Fleetwood and chassis manufacturer manuals for complete information.

5. Length taken from front bumper to rear bumper.

6. Excludes safety equipment and awnings.

7. Tank Manufacturer's listed water capacity (WC). Actual LPG capacity is 80% of water listing as required by the safety code.

Metric Conversions: Lbs. to kgs.: lbs. x .454 = kgs., Gallons to liters: gal. x 3.78 = ltrs.

IMPORTANT – PLEASE READ: Product information and photography included in this publication were as accurate as possible at the time of publication. For the most current product information and changes, please visit our website at www.fleetwoodrv.com or contact your local Fleetwood dealer. Subsequent refinements may be evident in the actual product. Prices and specifications are subject to change without notice. All weights, fuel, liquid capacities and dimensions are approximate. Fleetwood has designed its recreational vehicles to provide a variety of uses for its customers. Each vehicle features optimal seating, sleeping, storage and fluid capacities. The user is responsible for selecting the proper combination of loads to ensure that the recreational vehicle's capacities are not exceeded.